

Check Valve 4000

3/8" up to 3"

Non-return valve for backflow prevention

- All wetted parts stainless steel
- Compact design
- Sealing material PTFE

Technical Information

Nominal sizes	angle seat body rectangular body flange body	3/8" - 3" 1/2" - 2" 1/2" - 3"
Body material	stainless steel 316 L	
Material inner parts	stainless steel 316 Ti/301	
Material seating seal	PTFE (EPDM, NBR, FKM, PEEK)	
Connections	NPT-thread 3/8" - 3" welding ends tri clamp flanges acc. DIN EN 1092-1 flanges acc. ANSI 150	
Pressure class	580 psi	
pressure limitation	limitation for dangerous gases acc. Pressure equipment directive 97/23/EG (category I): $PS \text{ (psi)} \times DN \text{ (inch)} / 1.75 < 1000$	
Cracking/lifting pressure	ca. 3 psi (ca. 1.5 psi with reduced spring tension)	
Temperature range	-40°F up to +392°F	



Operating Pressures

Nominal size inch	adm. differential pressure (backpressure) psi seating seal	
	PTFE/PEEK	FKM / EPDM / NBR
3/8"	580	230
1/2"	580	230
3/4"	580	230
1"	580	230
1 1/4"	580	230
1 1/2"	580	230
2"	365	230
2 1/2"	365	230
3"	365	230

Dimensions and weights

Angle seat body

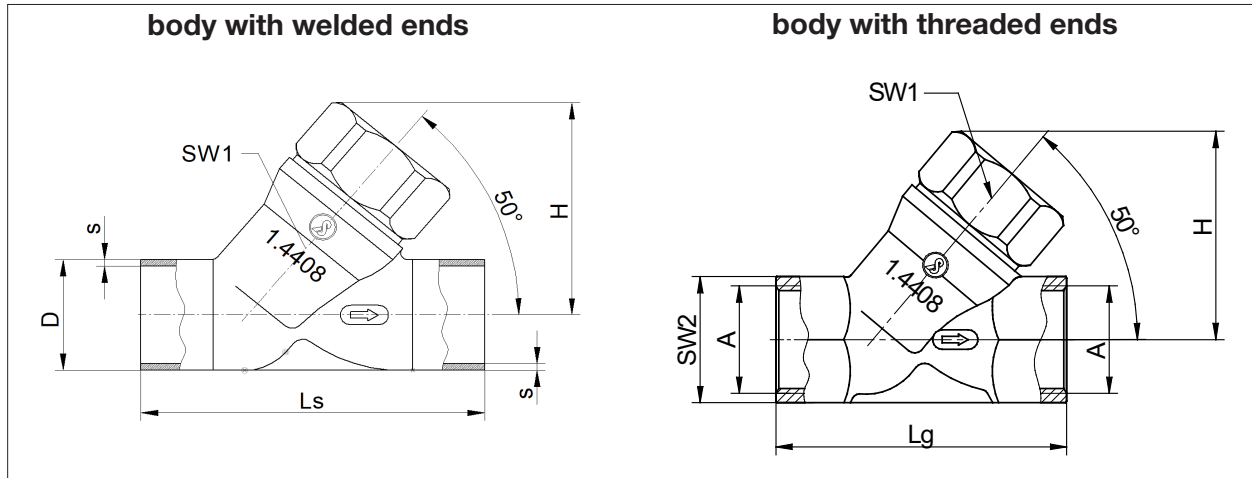

Size	with welding ends acc. ISO			with NPT-thread			H	SW1	Cv Value	Weight [lbs]
	D	s	Ls	A	SW2	Lg				
3/8"	-	-	-	3/8"	0.91	2.36	1.71	1.06	1.2	0.5
1/2"	0.84	0.08	3.15	1/2"	0.98	2.56	1.69	1.06	3	0.5
3/4"	1.06	0.09	3.54	3/4"	1.22	2.95	2.13	1.26	7	1
1"	1.33	0.1	3.94	1"	1.54	3.54	2.48	1.42	13.3	1.5
1 1/4"	1.68	0.1	4.33	1 1/4"	1.89	4.33	2.91	1.42	21.5	2.5
1 1/2"	1.9	0.1	4.72	1 1/2"	2.17	4.72	3.13	1.06	32.5	2.5
2"	2.37	0.11	5.91	2"	2.68	5.91	3.78	1.42	47.6	5
2 1/2"	3	0.11	7.09	2 1/2"	3.35	7.09	4.85	1.42	87	9
3"	3.5	0.13	8.66	3"	3.94	8.43	5.99	1.61	139.2	15.4

Dimensions in inch

Angle seat body

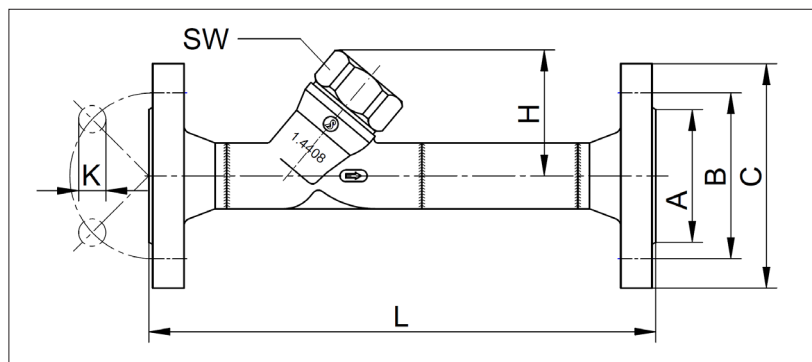

Size	PN40 (DN65 and DN80 PN16)					ANSI 150					H	L	Weight [lbs]
	A	B	C	N (Number of holes)	K	A	B	C	N (Number of holes)	K			
1/2"	1.77	2.56	3.74	4	0.55	1.37	2.37	3.54	4	0.62	1.69	9.06	4
3/4"	2.28	2.95	4.13	4	0.55	1.69	2.75	3.94	4	0.62	2.13	10.24	6.4
1"	2.68	3.35	4.53	4	0.55	2	3.13	4.33	4	0.62	2.56	10.24	7.5
1 1/4"	3.07	3.94	5.51	4	0.71	2.5	3.5	4.53	4	0.62	3.11	11.81	11.5
1 1/2"	3.46	4.33	5.91	4	0.71	2.87	3.87	4.92	4	0.62	3.15	11.81	12.6
2"	4.02	4.92	6.5	4	0.71	3.63	4.75	5.91	4	0.75	3.82	13.78	19.4
2 1/2"	4.8	5.71	7.28	8	0.71	4.13	5.5	7.09	4	0.75	4.84	15.75	25.6
3"	5.43	6.3	7.87	8	0.71	5	6	7.48	4	0.75	5.98	17.72	32.9

Dimensions in inch

Rectangular body

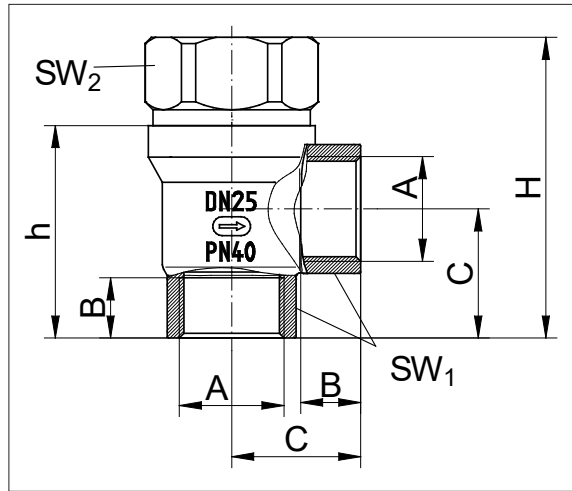

Size	with NPT-thread		with NPT-thread		C	SW1	SW2	h	H	Weight [lbs]
	A	B	A	B						
1/2"	G 1/2"	0.59	NPT 1/2"	0.57	1.61	0.98	1.26	2.52	2.95	3
3/4"	G 3/4"	0.64	NPT 3/4"	0.59	1.61	1.26	1.42	2.6	3.48	3.5
1"	G 1"	0.75	NPT 1"	0.7	1.61	1.61	1.42	2.66	3.76	4.5
1 1/4"	G 1 1/4"	0.84	NPT 1 1/4"	0.72	2.56	1.97	1.06	3.66	4.94	5
1 1/2"	G 1 1/2"	0.84	NPT 1 1/2"	0.72	2.56	2.17	1.42	3.98	5.51	7.5
2"	G 2"	1.01	NPT 2"	0.72	2.56	2.68	1.42	4.57	6.56	11.5

Dimensions in inch

Flanged body

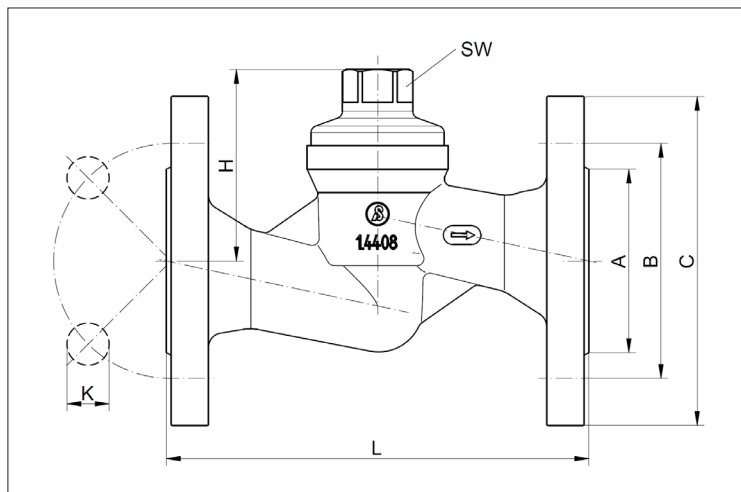

Size	Flanges acc. EN 1092-1; Face to face dimension acc. EN 558-1						Flanges acc. ASME B16.5; Face to face dimension acc. ANSI/ISA-75.08.01						H	SW	Weight [lbs]
	L	C	B	A	N (Number of holes)	K	L	C	B	A	N (Number of holes)	K			
1/2"	5.12	3.74	2.56	1.77	4	0.55	7.24	3.5	2.38	1.38	4	0.62	1.73	1.26	8.2
3/4"	5.91	4.13	2.95	2.28	4	0.55	7.24	3.88	2.75	1.69	4	0.62	2.4	1.42	8.4
1"	6.3	4.53	3.35	2.68	4	0.55	7.24	4.25	3.12	2	4	0.62	2.83	1.42	9.7
1 1/4"	7.09	5.51	3.94	3.07	4	0.71	7.87	4.62	3.5	2.5	4	0.62	3.23	1.06	13.5
1 1/2"	7.87	5.91	4.33	3.46	4	0.71	8.74	5	.88	2.88	4	0.62	3.9	1.42	17.9
2"	9.06	6.5	4.92	4.02	4	0.71	10	6	4.75	3.62	4	0.75	5.16	1.42	25.6
2 1/2"	11.42	7.28	5.71	4.8	8	0.71	-	-	-	-	-	-	5.59	-	44.1
3"	12.2	7.87	6.3	5.43	8	0.71	-	-	-	-	-	-	7.01	-	58

Dimensions in inch

Text and pictures are not binding. We reserve the right to alter the equipment.